



## 2-MD-SC Magnetic Drive – Semi Corrosive Fluids

Circulation semi corrosive acids, alkalis, solvents, brine, plating solutions. sterile solutions. and other moderately corrosive chemicals and solutions that are compatible construction

- Volute, magnet housing and impeller are glass-filled poly-propylene for excellent chemical resistance
- Encapsulated glass-filled poly-propylene permanent impeller magnet
- Ceramic shaft and thrust washers are 99.5% pure alumina for excellent wear and trouble-free service
- 1/30 HP open FC motor
- 1.1 specific gravity
- Nitrile O-ring



**Note: In-Line Only**

<b>RPM:</b>	2700/3000
<b>Capacity:</b>	28 LPM
<b>Shut Off:</b>	3.2m
<b>Liquid Temp:</b>	66°C
<b>Discharge:</b>	12.7mm
<b>Intake:</b>	12.7mm
<b>Electrical:</b>	230V, 50Hz/60Hz, 105 Watts
<b>MODEL:</b>	<b>580513</b>

Performance Curves 2-MD-SC 230V, 50/60Hz

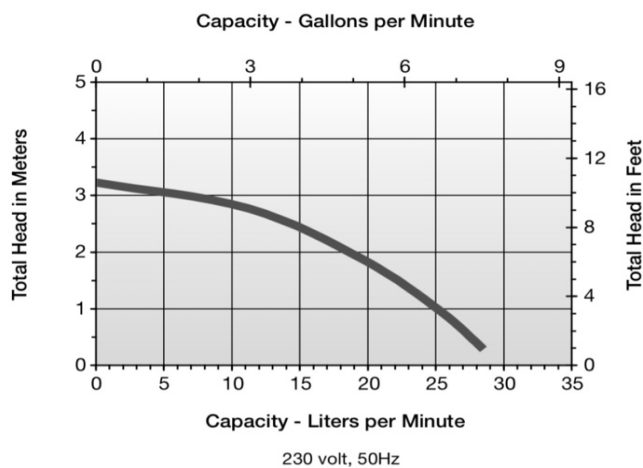



## 2-MD-SC

### PUMP MATERIALS

The plastic parts on SC series pumps are made of glass-filled polypropylene. The plastic parts on the HC series pumps are glass filled PPS. The spindle shaft which is stationary and the captive thrust washers (front and rear) are alumina ceramic. The O-ring seal is Nitrile for the SC series, and Fluoroelastmer (FKM) for the HC series. The HC series utilizes a pure carbon bushing in the impeller to enable the pump to run dry for periods up to eight hours at a time.

### INSTALLATION

Your Little Giant pump is delivered to you completely preassembled and pretested from the factory. It is ready for immediate use. The pump may be installed in any position.

It may be mounted vertically with the pump head down. Proper plumbing connections should be made. See specification table to determine what size intake and discharge your pump has. Use a thread sealer on all pipe connections and hand tighten only. Note: On HC models a roll of PTFE pipe seal tape is supplied. Do not use a wrench to tighten the HC model connections. Excessive force may damage the plastic part.

Make sure the wing nuts are tight before operating the pump.

Motor nameplates list all electrical data. Make sure the pump is connected to proper voltage before operating. When wiring pumps with no plug, the green (or green/yellow) wire is the ground. The other two wires are line (live). If fused type plug is used, a 2.0 amp fuse is recommended.

Do not allow the SC models to run dry (without fluid). However, because the HC models utilize a carbon bushing in the impeller they may be allowed to run dry for periods up to eight hours at a time. These pumps are not submersible. Operate the pumps only in the in-line mode. Do not put the units in liquid. Pump should be installed in a dry area and protected from splash. These pumps are not self priming models. **IMPORTANT:** These pumps must be installed so that the pump head (volute) is flooded before starting. That is, the inlet of the pump must be below the level of the surface of the liquid being pumped (Fig. 1).

FIGURE 1

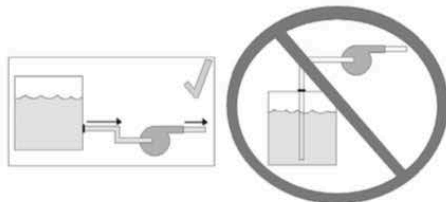

Do not restrict the intake side of the pump. Connections on the intake side should not be of smaller inside diameter pipe or tubing or hose than the intake inside diameter

of the intake thread designation. If reduced flow is required restrict the discharge side. Installing a valve or other type of restriction device on the discharge side is the proper method for reducing flow from the pump. When using a valve the pump can be throttled to provide various flow rates and pressures without harming the motor or the pump parts.

### **MAKE CERTAIN THE UNIT IS DISCONNECTED FROM THE POWER SOURCE BEFORE ATTEMPTING TO SERVICE OR REMOVE ANY COMPONENT!**

1. The motor's sleeve bearings should be lubricated every six months with two to three drops of S.A.E. 20 weight non-detergent oil. The oil holes are located on top at each end of the motor.
2. All wetted parts can be serviced by removing the 4 wing nuts (item 11) to the housing. The pump head components can be replaced in the field if necessary.
3. Lightly clean any corrosion or debris which may clog the impeller.
4. If pump is stripping circuit breakers, GFCI, or not operating properly after cleaning, return to a Little Giant authorized service center. **DO NOT** attempt repairs yourself.
5. Be certain power cord is in good condition and contains no nicks or cuts.